

Staging Area

**BRC
RE-4**

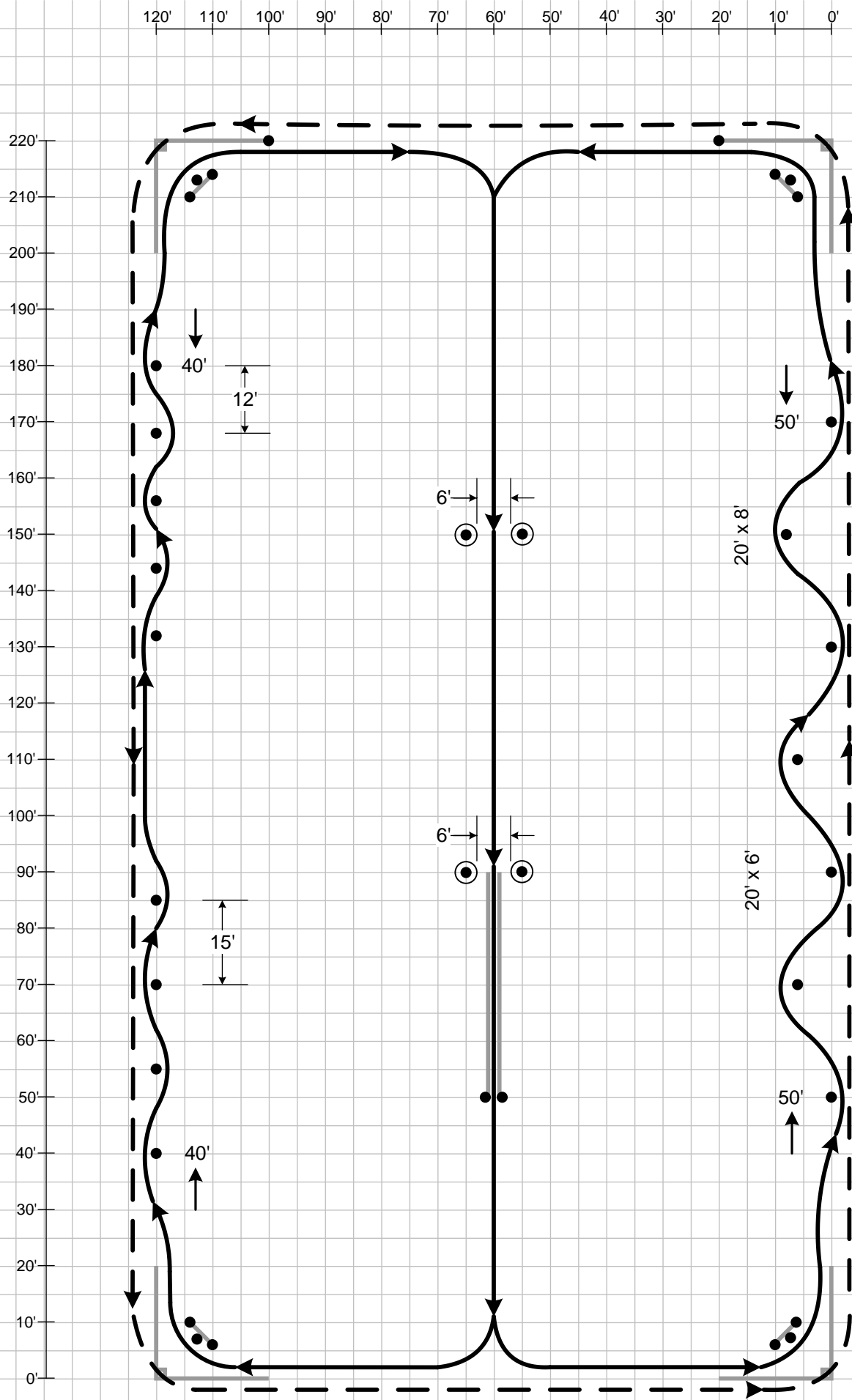

Staging Area

**BRC
RE-5**

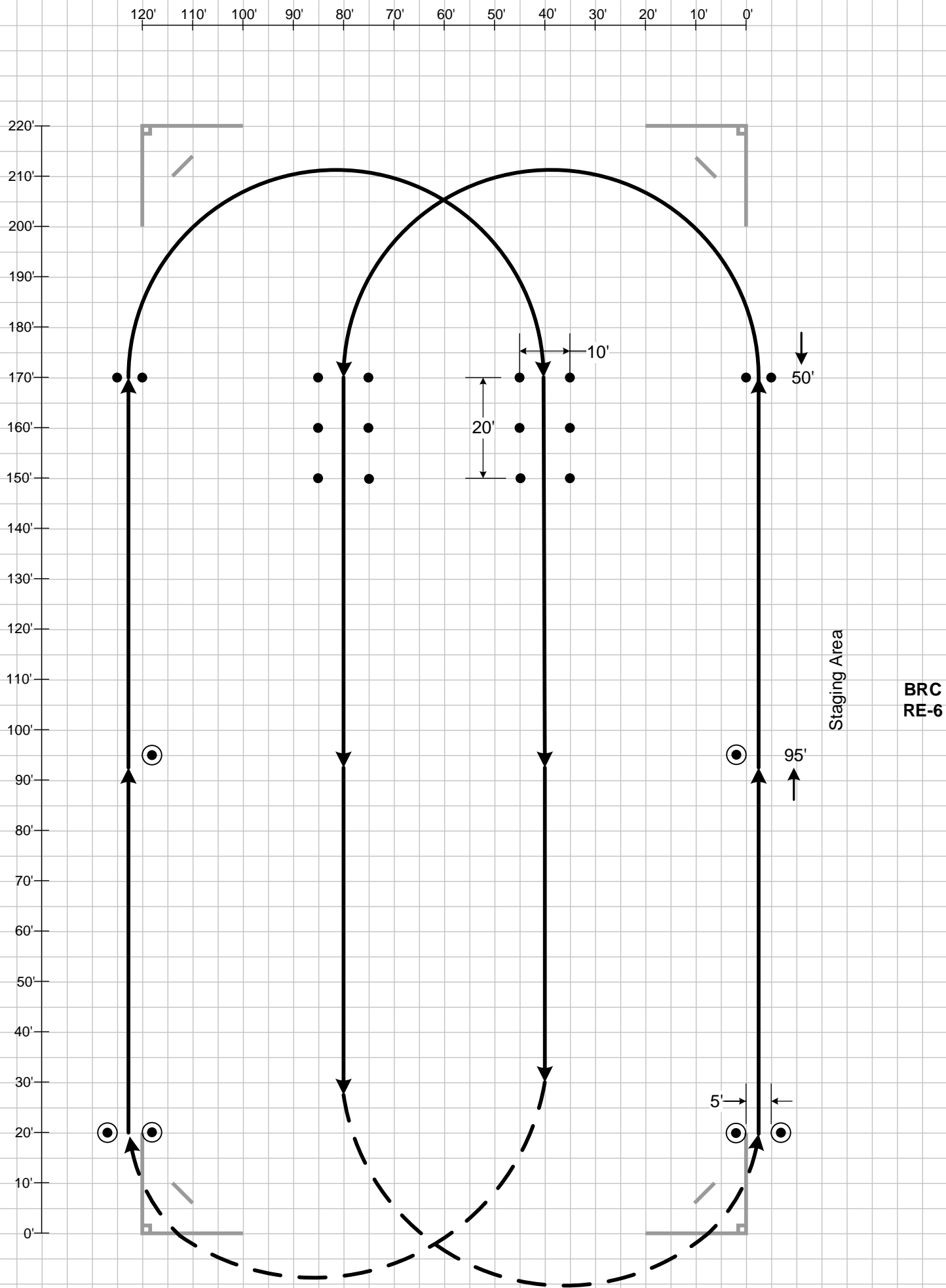

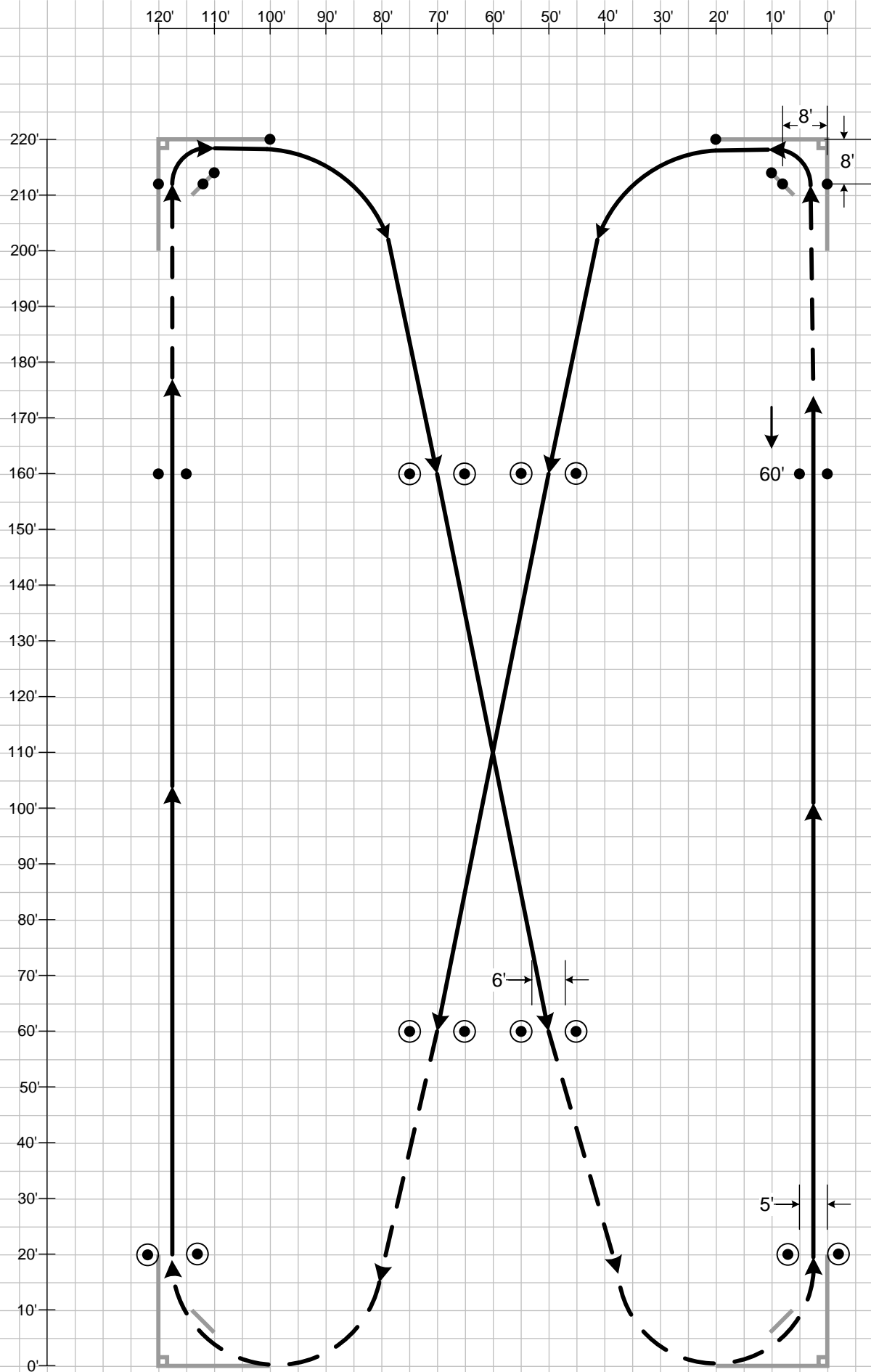

Staging Area

**BRC
RE-7**

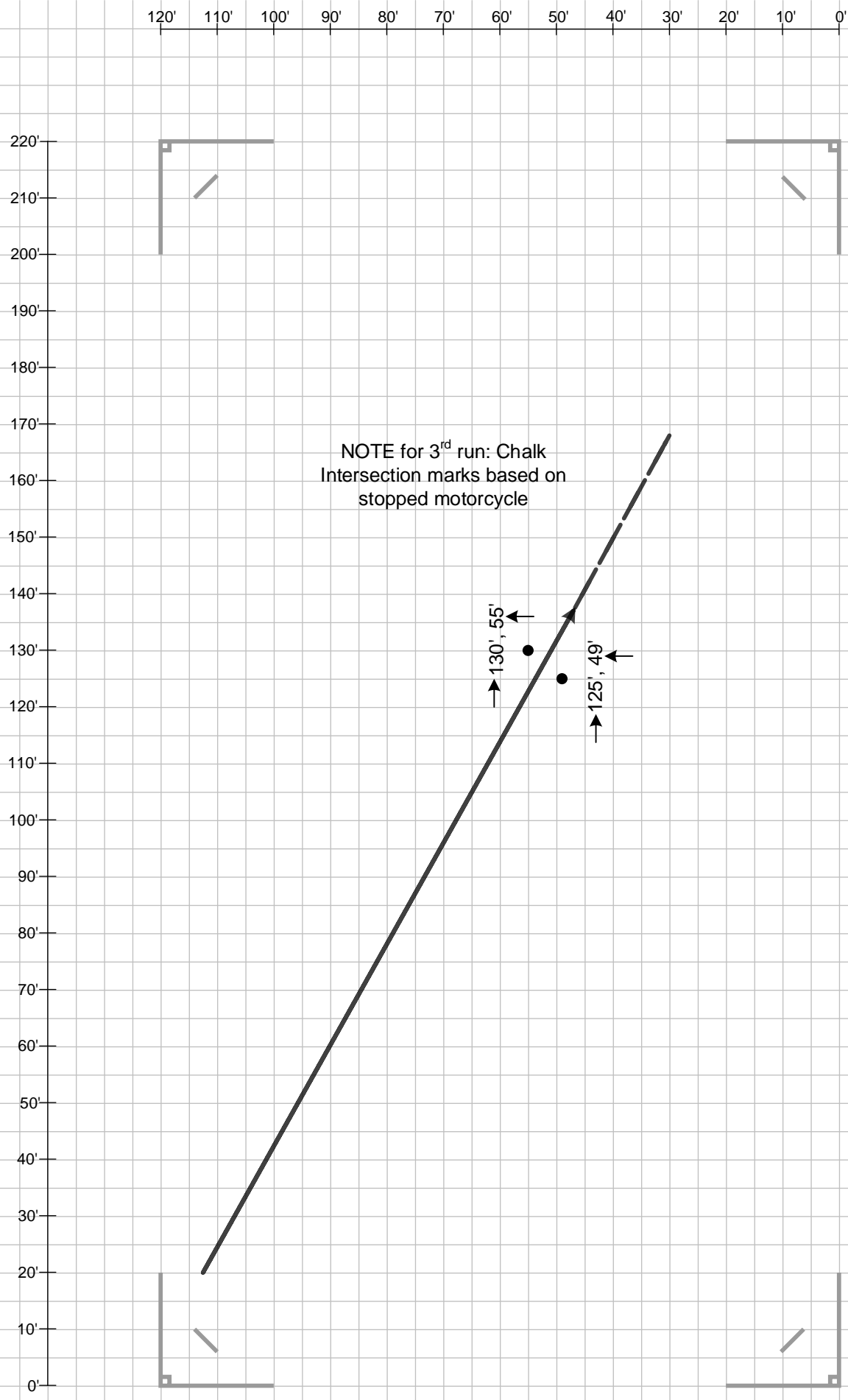

Staging Area

**BRC
RE-8**

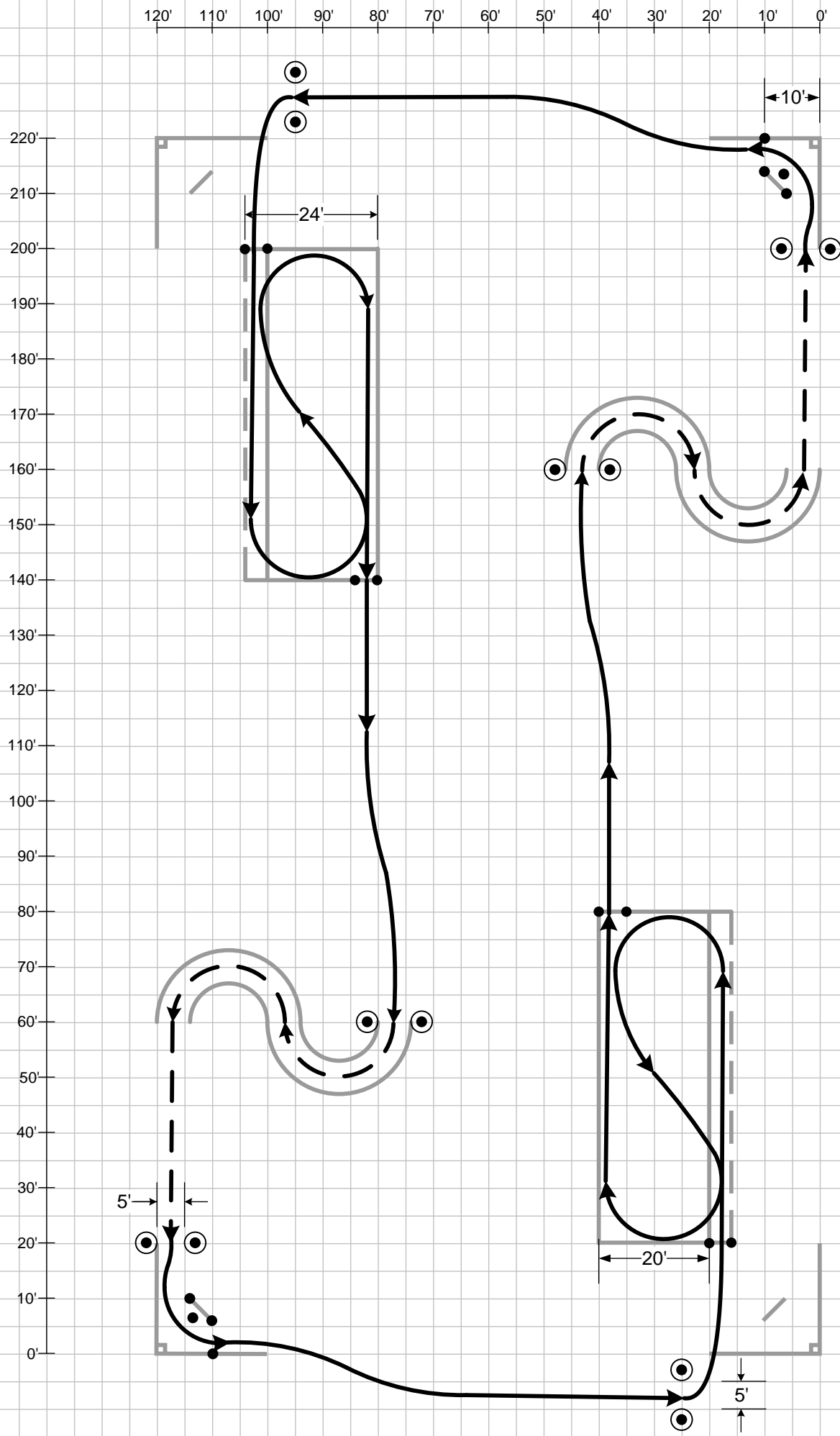

Staging Area

**BRC
RE-9**

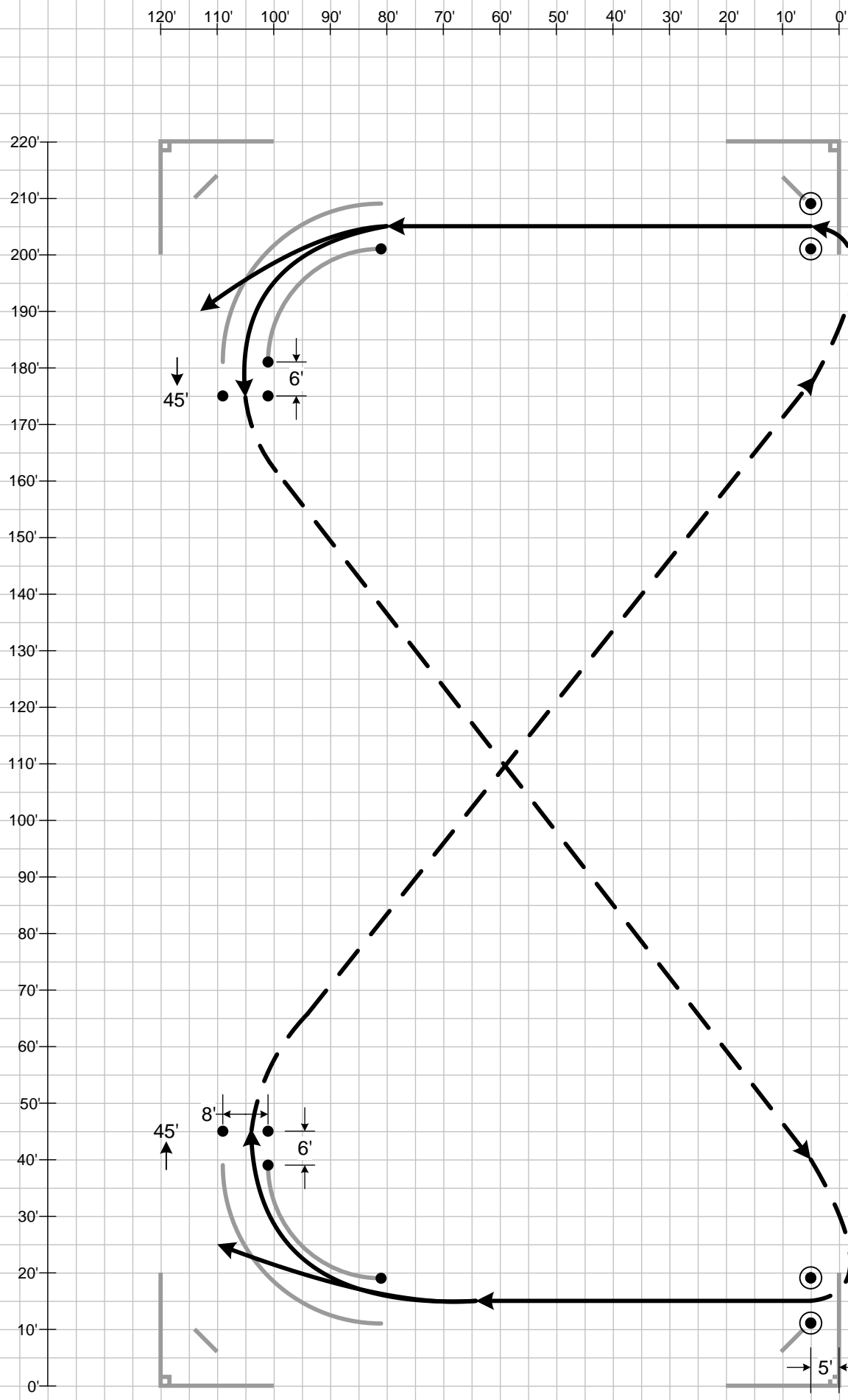

Staging Area

**BRC
RE-10**

120' 110' 100' 90' 80' 70' 60' 50' 40' 30' 20' 10' 0'

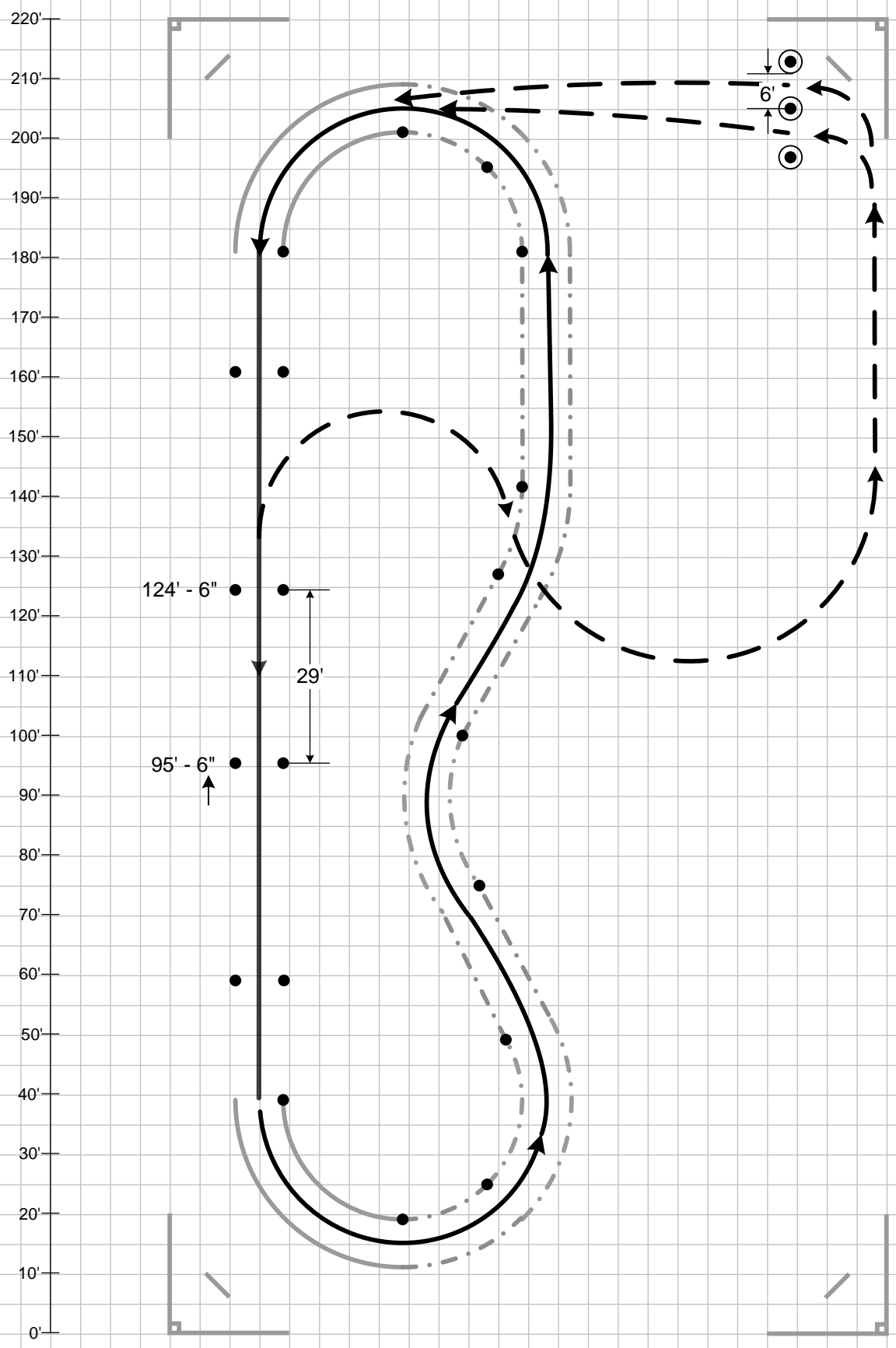

124' - 6"

95' - 6"

29'

6'

Staging Area

**BRC
RE-11**

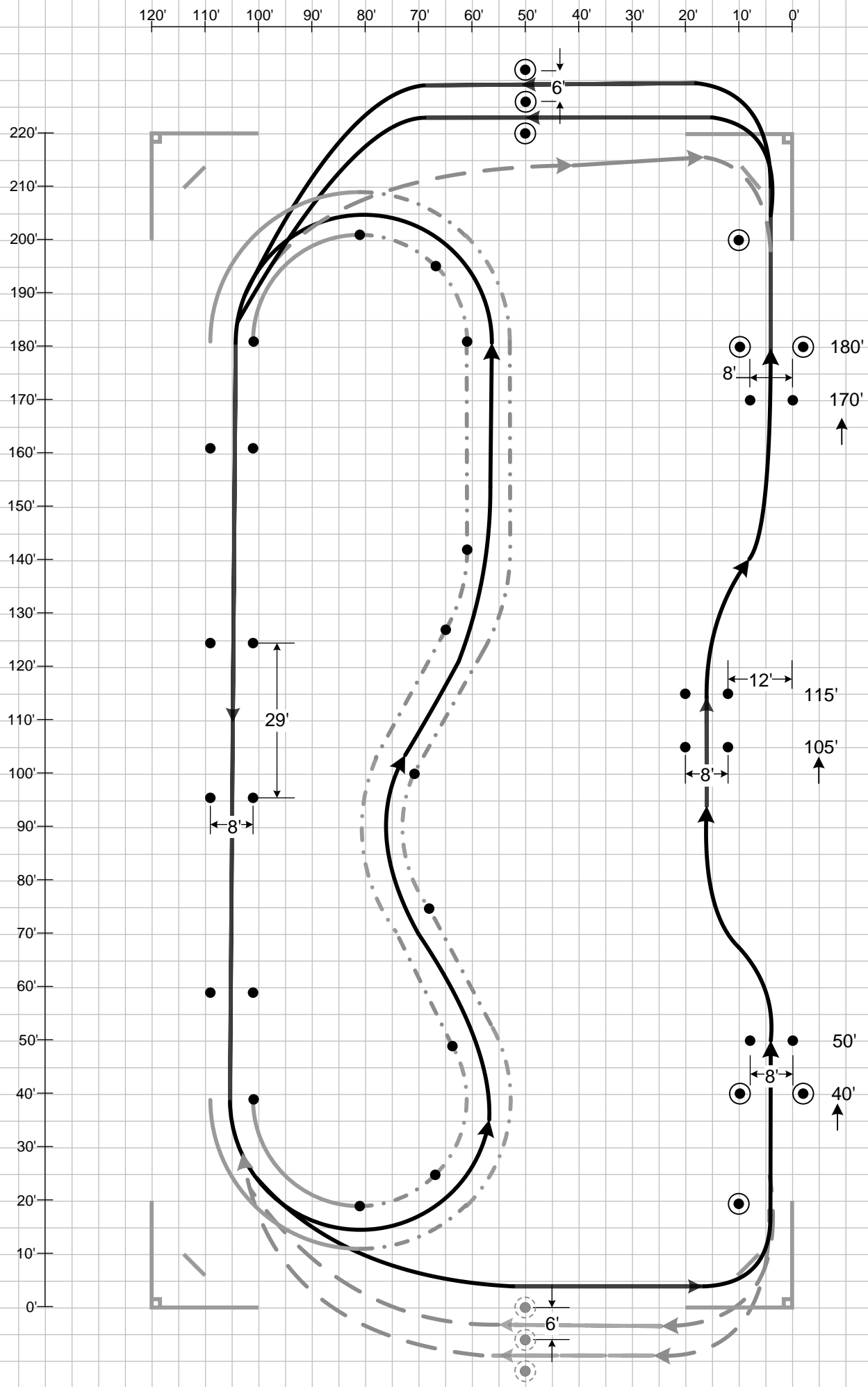

Staging Area

**BRC
RE-12**

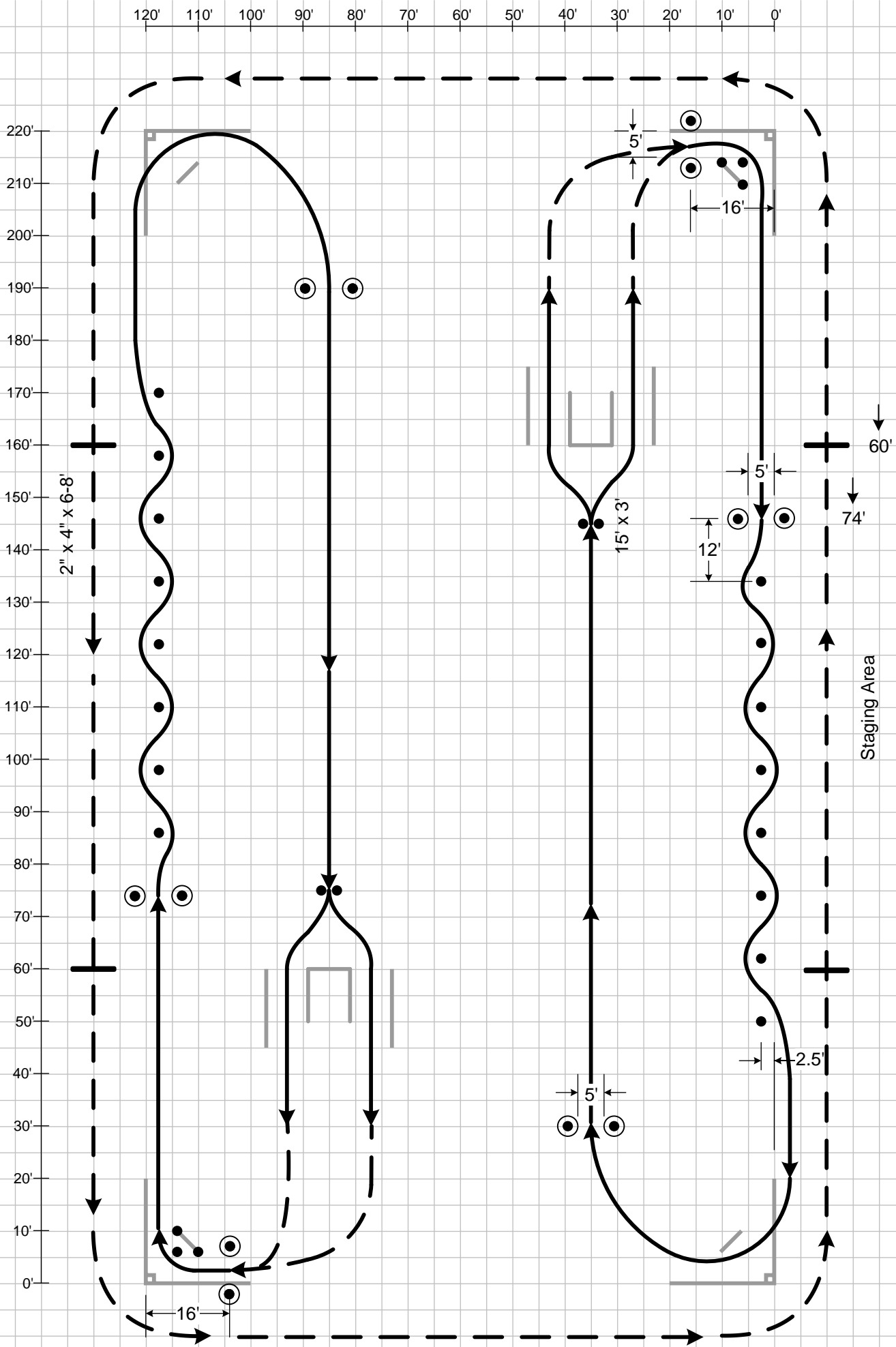

Staging Area

**BRC
RE-13**

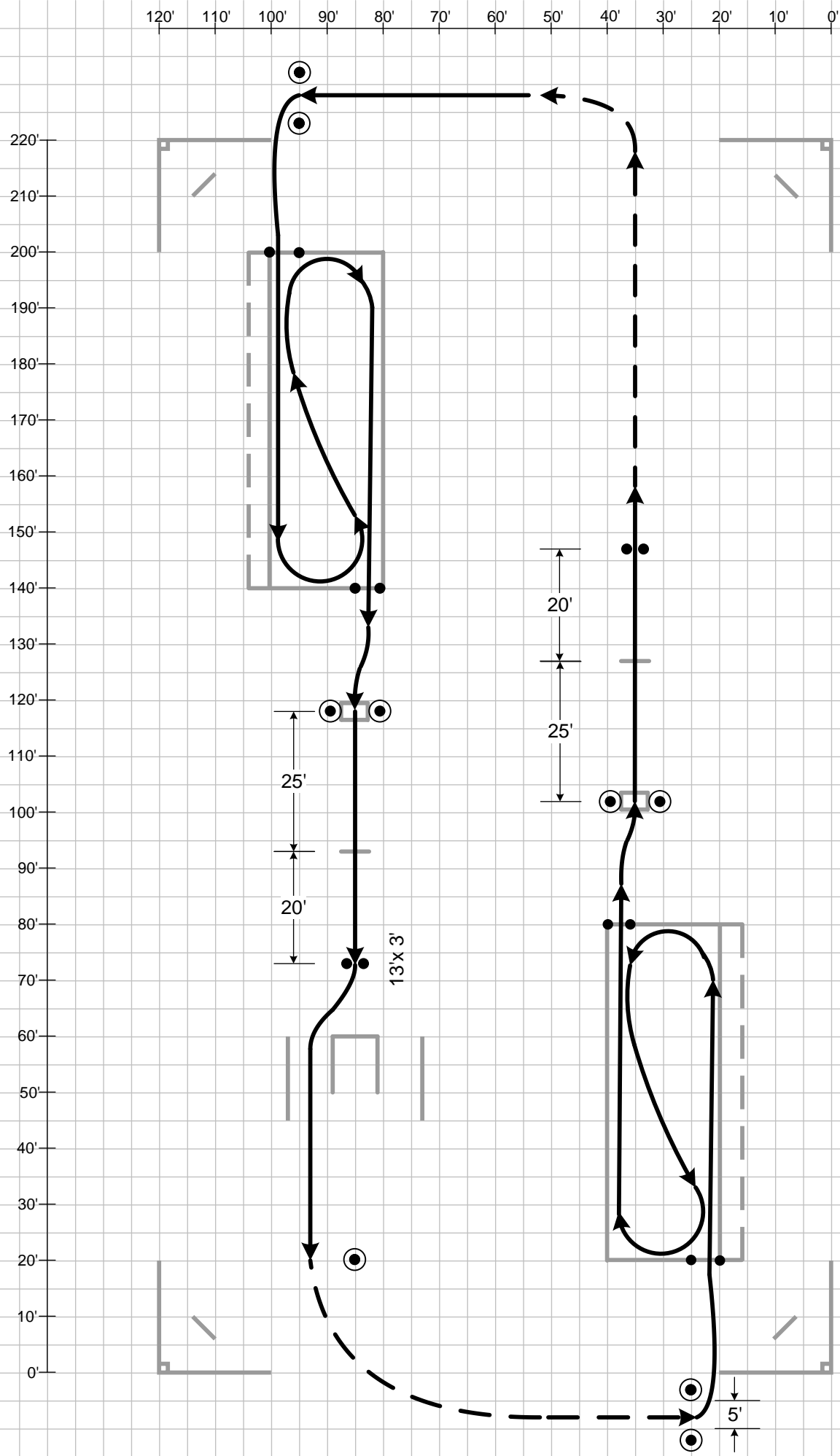

Staging Area

**BRC
RE-14**

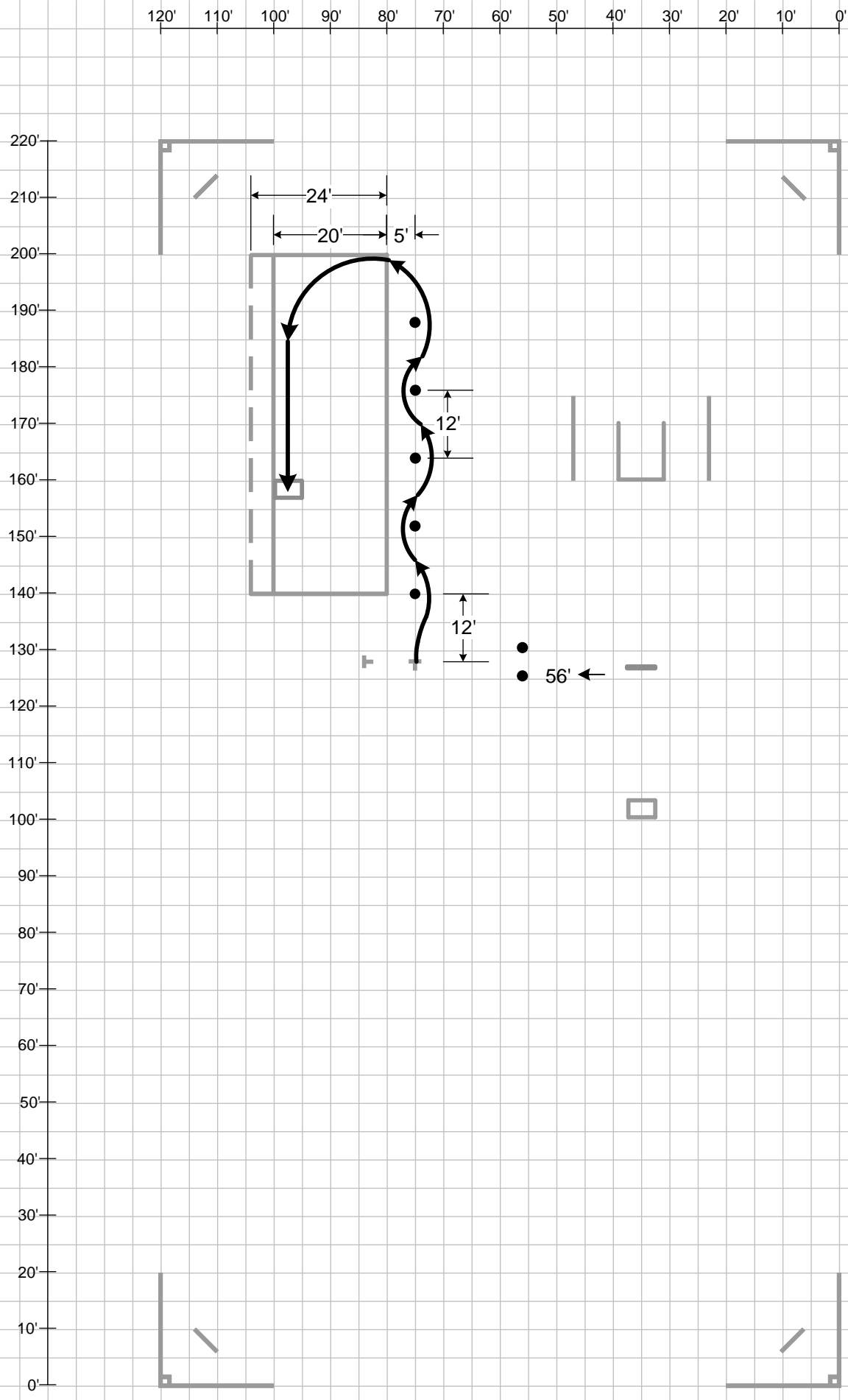

Staging Area

**BRC
SE-1**

120' 110' 100' 90' 80' 70' 60' 50' 40' 30' 20' 10' 0'

220'
210'
200'
190'
180'
170'
160'
150'
140'
130'
120'
110'
100'
90'
80'
70'
60'
50'
40'
30'
20'
10'
0'

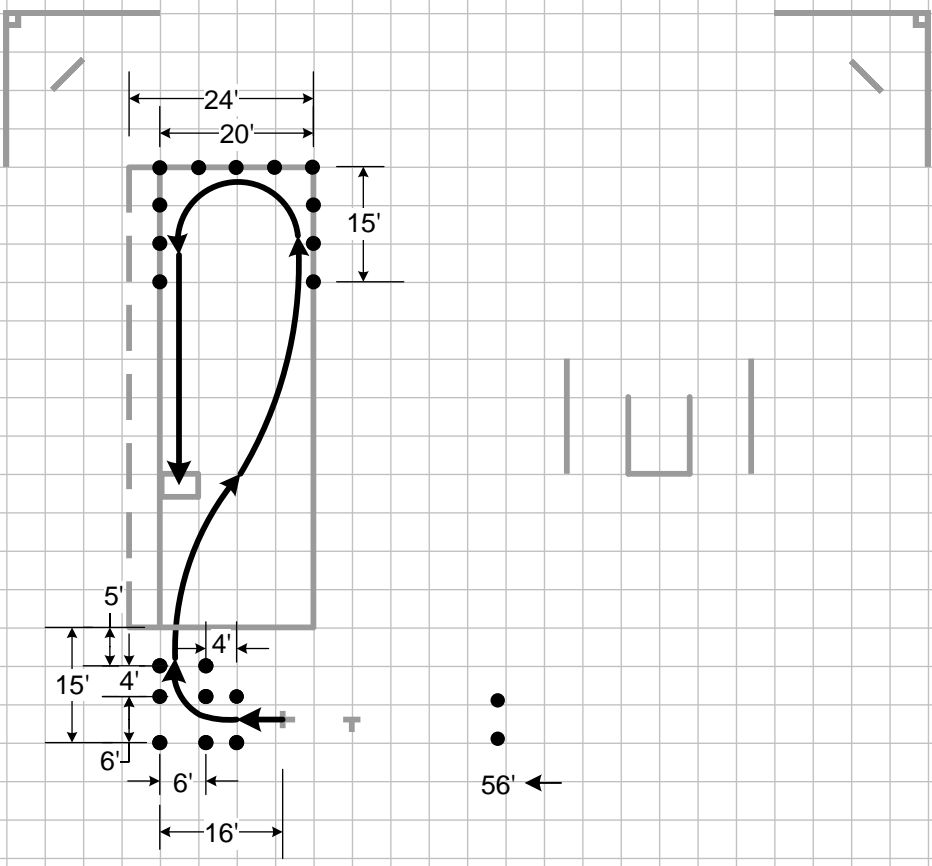

Staging Area

**BRC
SE-2**

NOTE: Diagram shown is for motorcycles of less than 600cc engine displacement; riders are allowed 20' width for the left U-Turn.

For motorcycles of 600cc or more, riders are allowed 24' width for the left U-Turn. Adjust the position of the stop box and left boundary line accordingly.

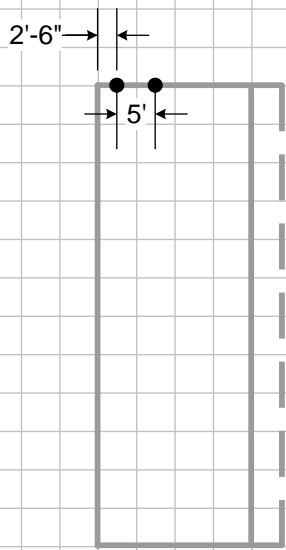

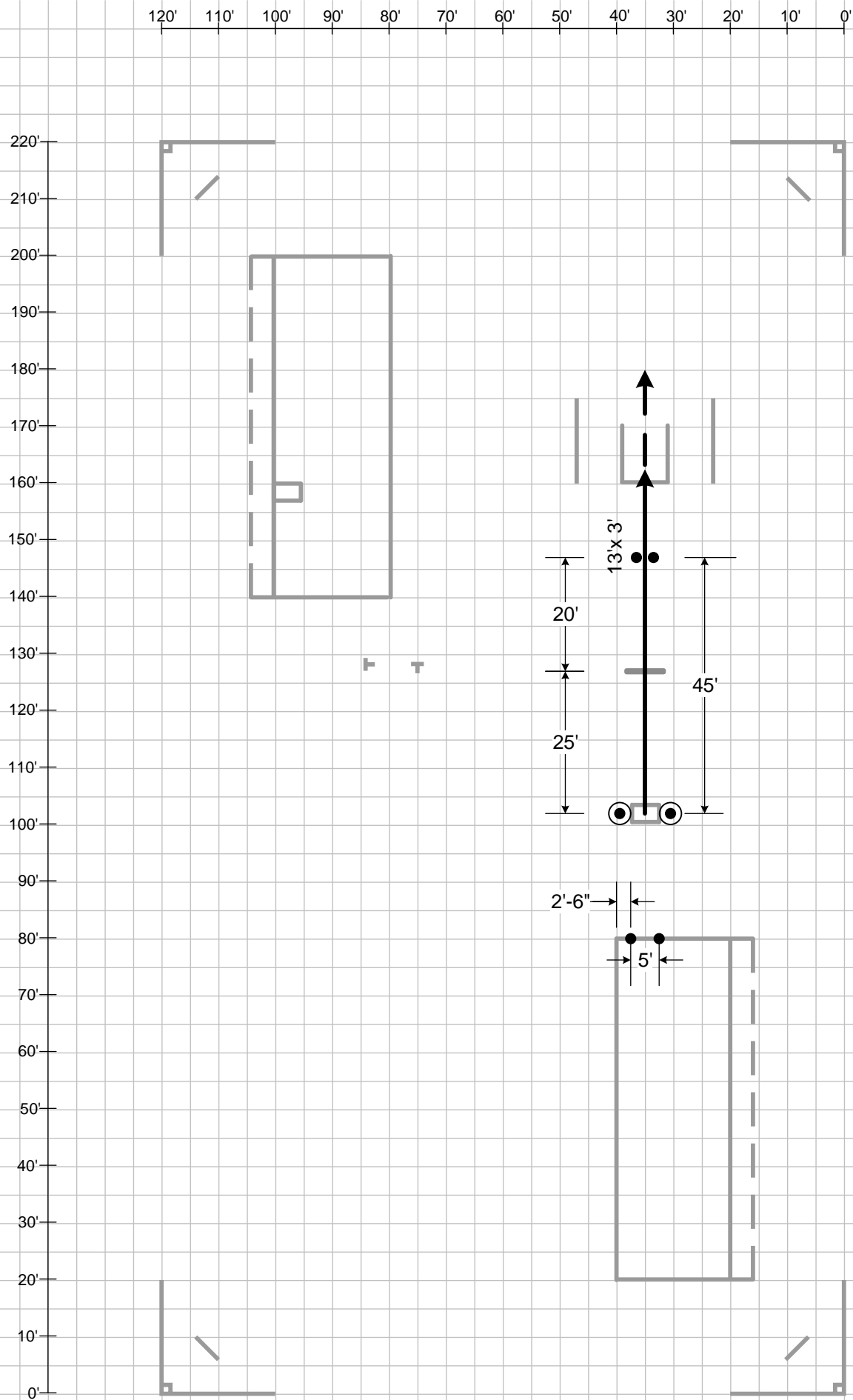

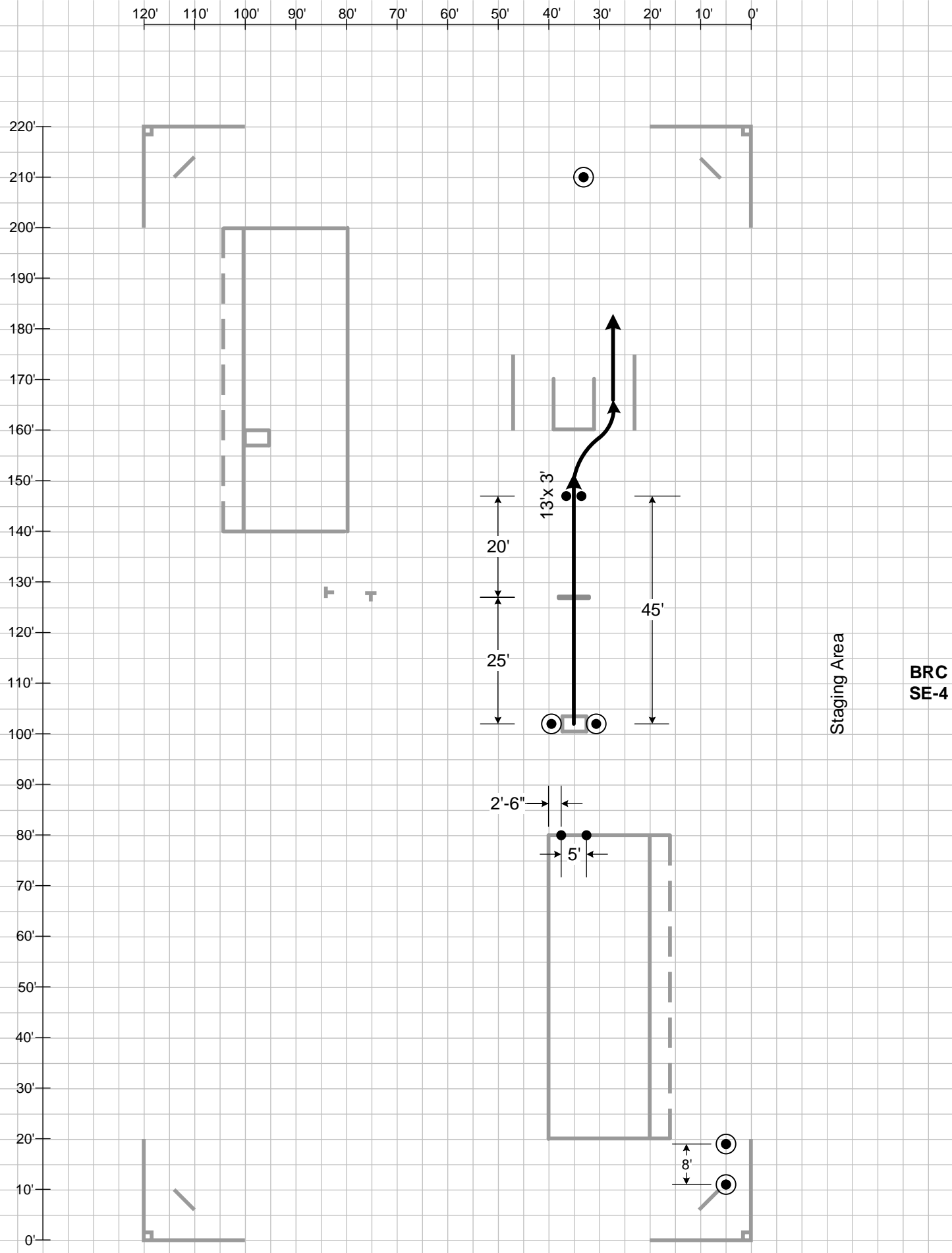

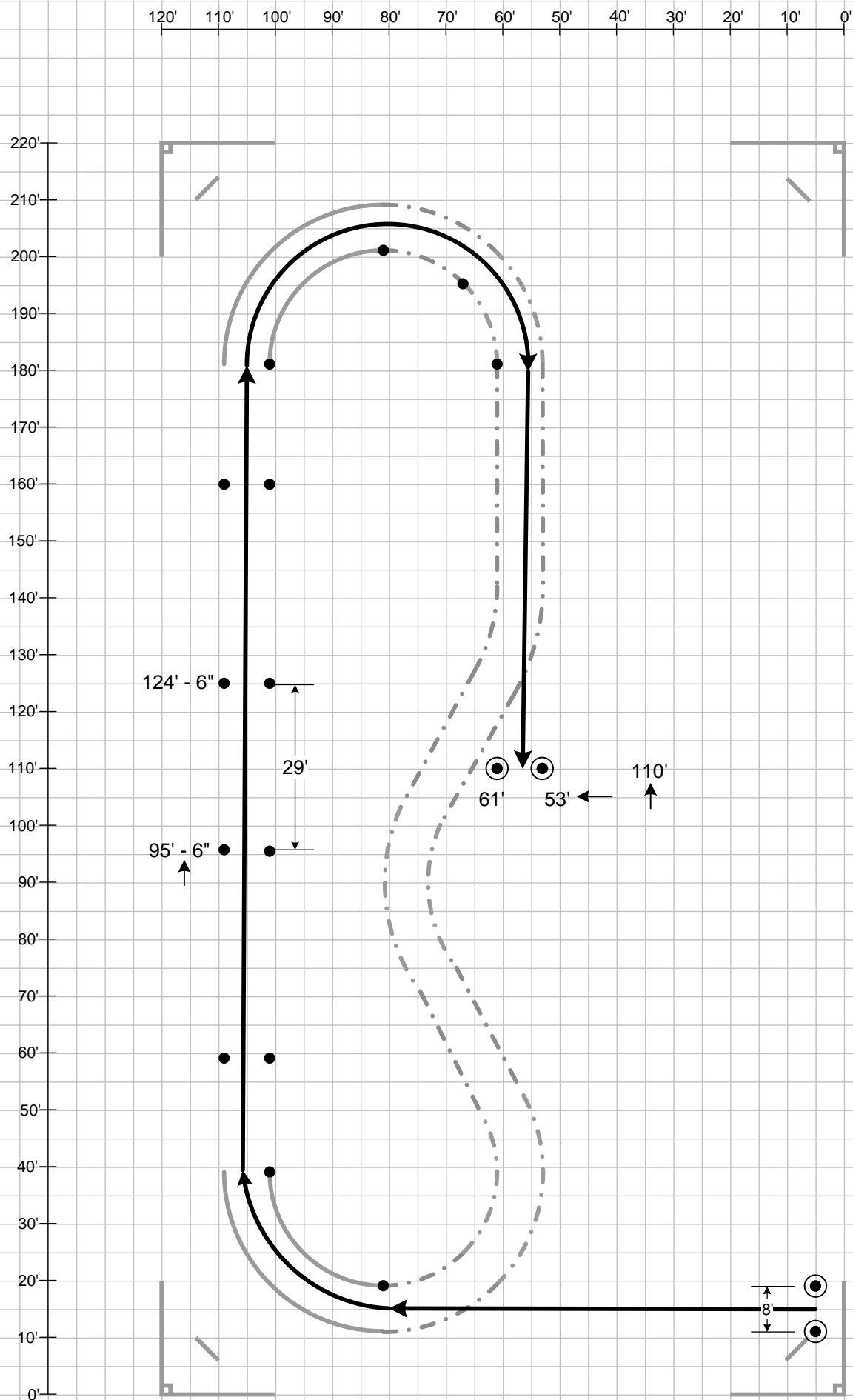

Staging Area

**BRC
SE-5**